

iOS Security Certificate Installation for WG1000 Web Gateway HTML Pages



Download the certificate from www.atmos.eu/en/downloads



Allow configuration profile download



Select the device where the certificate will be installed



Tap „Close“

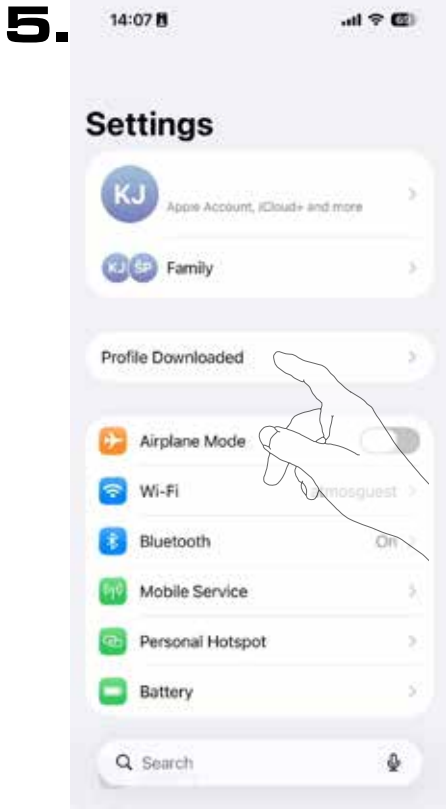

Go to Settings and tap „Profile Downloaded“.

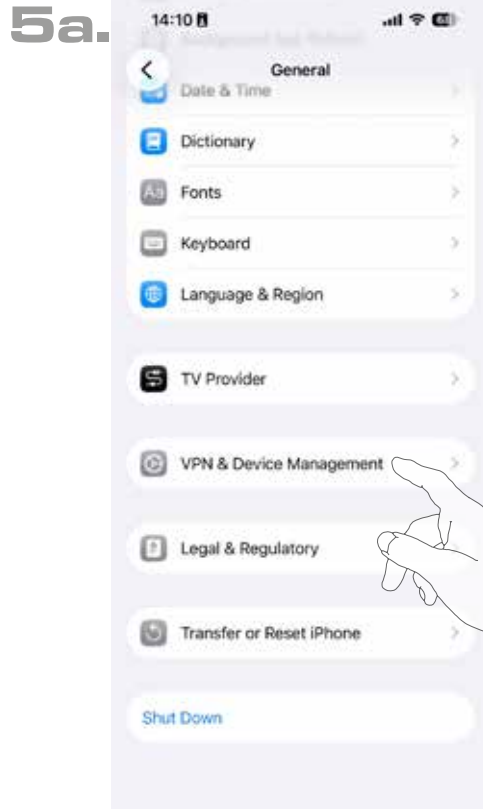

If „Profile Downloaded“ does not appear, go to Settings -> General -> VPN & Device Management. The certificate configuration profile is located here. You can also delete the profile here.

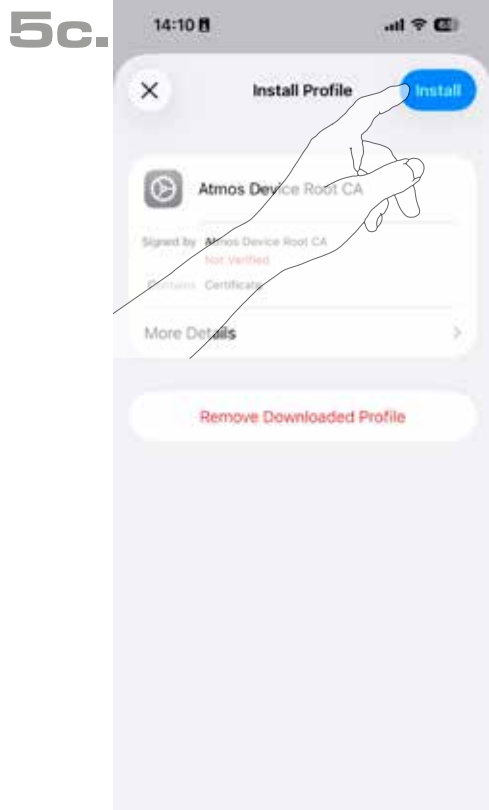
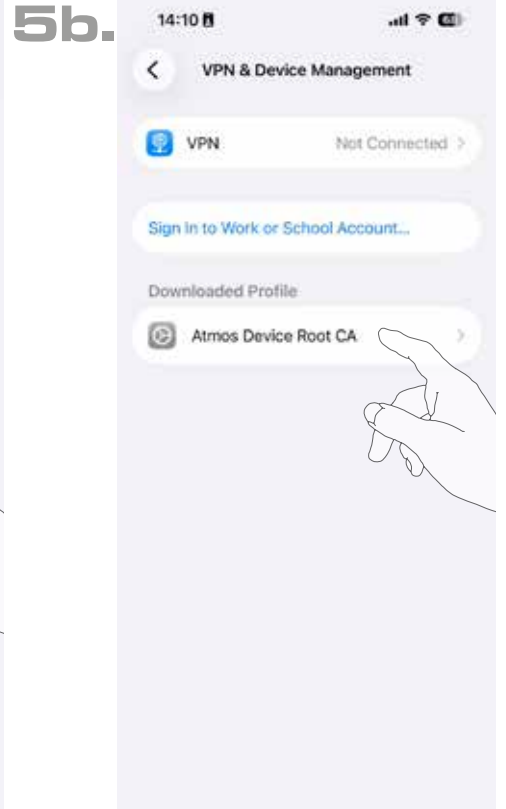

Tap „Install“

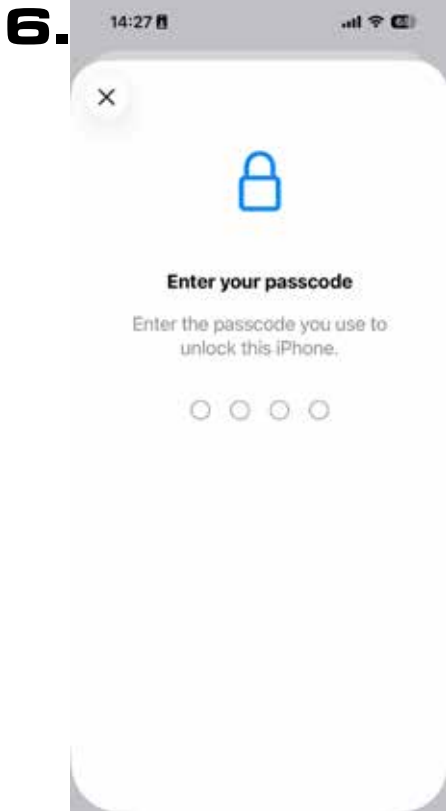

Enter your passcode (PIN).

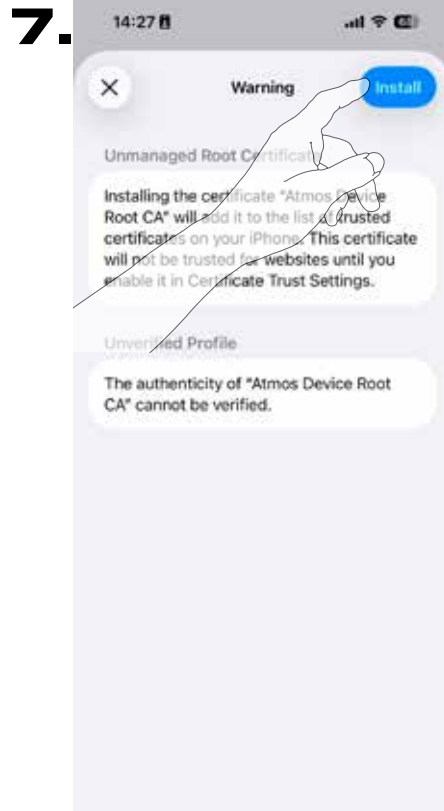

Tap „Instal“

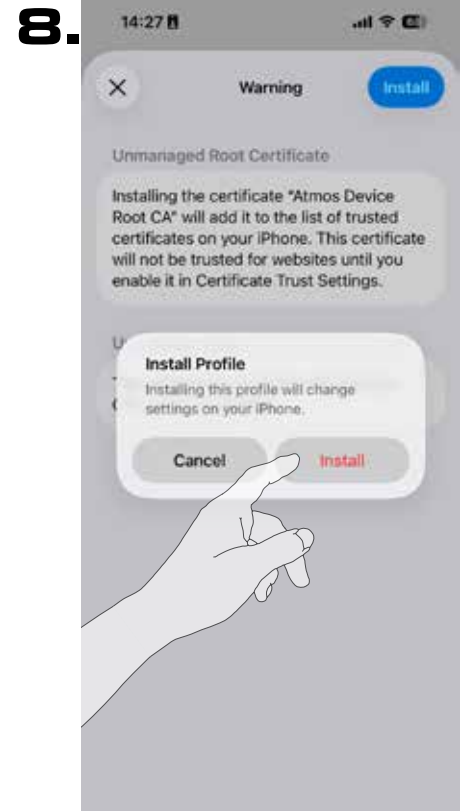

Confirm „Instal“

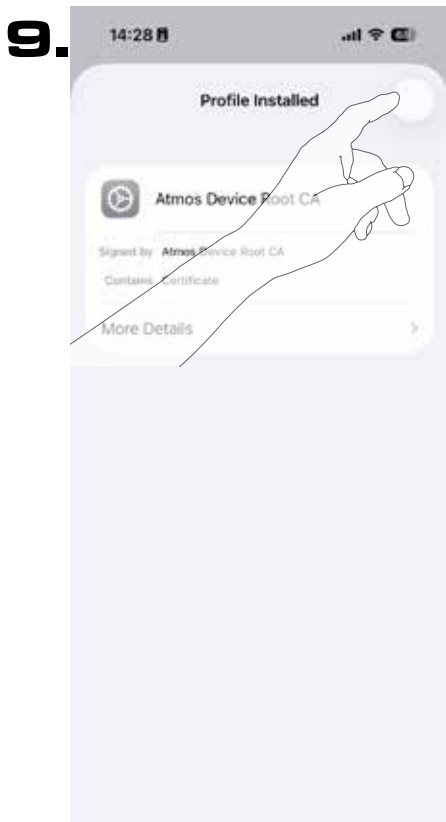

Confirm. The profile is installed. Now, it is necessary to enable full trust for the certificate.

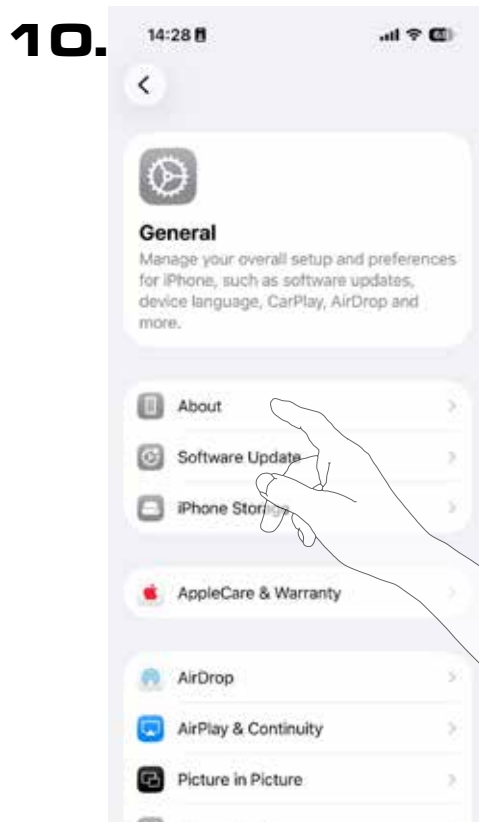

Settings -> General -> About

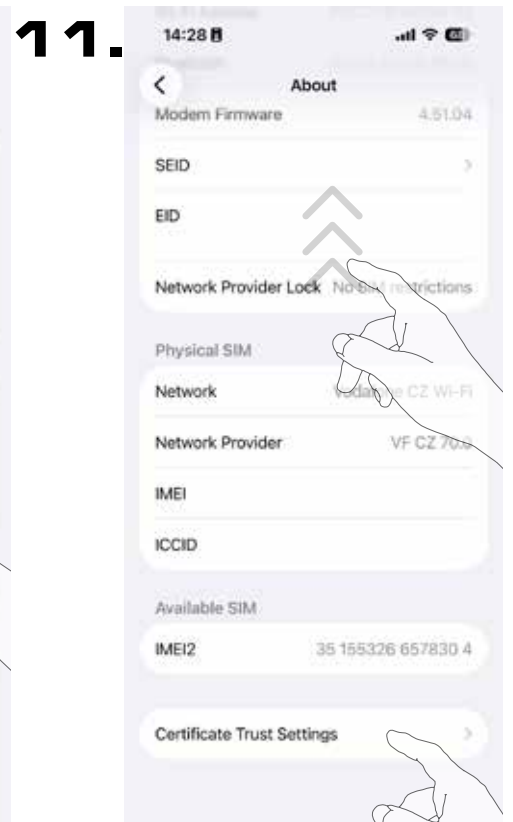

Scroll all the way down in the „About“ section and tap „Certificate Trust Settings“.

12.

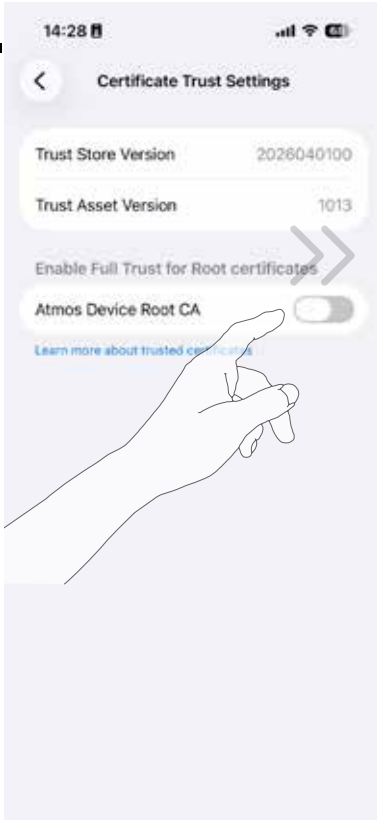

Enable for full trust

13.

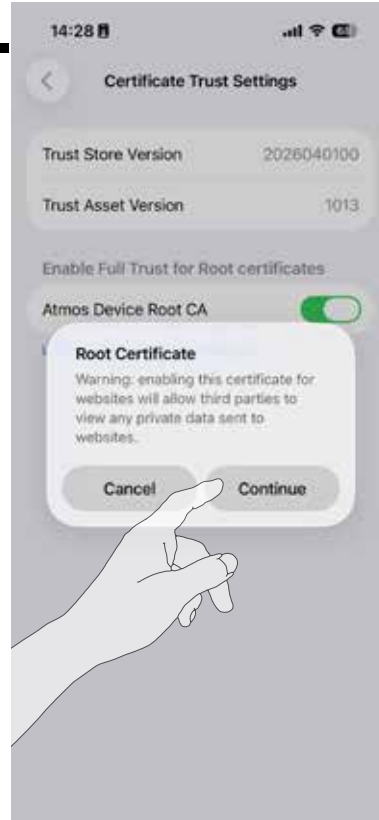

Tap to „Continue“

14.

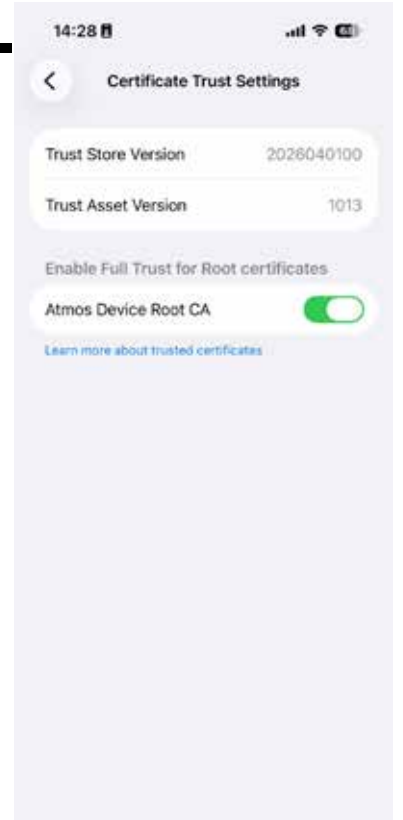

DONE